

KENTUCKY EXTENSION HOMEMAKERS ASSOCIATION

KEHA, WE'VE GOT YOU COVERED

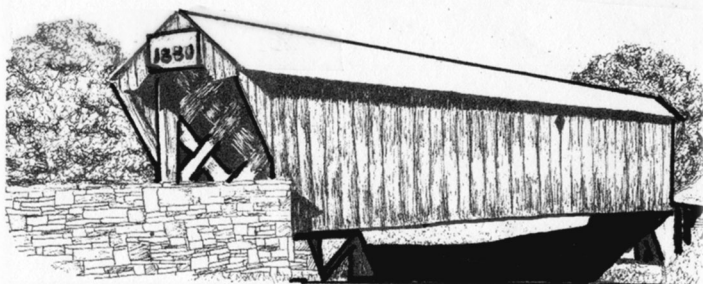

88th Annual Meeting
May 10-12, 2022
Owensboro Convention Center
Owensboro, Kentucky

Kentucky Extension Homemakers Association



88th Annual Meeting
May 10-12, 2022
Owensboro Convention Center
Owensboro, Kentucky

WELCOME TO OWENSBORO

(Times listed are Central Daylight Time)



Tuesday, May 10

- 8:00 a.m.—10:30 a.m. Trade Show Set-Up Exhibit Hall 1
 Silent Auction and Basket Raffle Set Up Exhibit Hall 1
 KEHA Showcase Set Up Exhibit Hall 1
- 9:00 a.m.—5:00 p.m. Registration Registration 3
 Voting Delegate Sign-In Registration 2
- 9:00 a.m.—12:00 p.m. Cultural Arts Check-In Exhibit Hall 2
 9:00 a.m.—Green River and Licking River
 9:30 a.m.—Bluegrass and Louisville
 10:00 a.m.—Northern Kentucky and Fort Harrod
 10:30 a.m.—Lincoln Trail and Lake Cumberland
 11:00 a.m.—Pennyrile, Wilderness Trail, and Mammoth Cave
 11:30 a.m.—Purchase, Northeast, and Quicksand
- 9:00 a.m.—12:00 p.m. Quilt Square Check-In Lower Lobby 3
- 10:30 a.m.—5:30 p.m. Trade Show Open Exhibit Hall 1
 KEHA Merchandise Store Exhibit Hall 1
 Basket Raffle, Silent Auction, and KEHA Showcase Exhibit Hall 1
- 10:30 a.m.—11:30 a.m. Hands-On Creative Classes—Session 1
 Snowman Measuring Stick German-American Bank A
 Snowman Lightbulb Ornament German-American Bank B (split)
 Mason Jar Tissue Holder German-American Bank B (split)
 Rainbow Charm Bracelet German-American Bank C (split)
 Jr. Legal Pad Decorative Cover German-American Bank C (split)
 Red Work/Blue Work German-American Bank D (split)
 No Sew Quilt Block German-American Bank D (split)
 Travel Kit MR210
 Candlewicking MR231

LUNCH ON YOUR OWN

- 11:30 a.m.—1:30 p.m. **One-Pass Buffet Lunch available for \$13** Lower Lobby
Roasted pork with bourbon sauce with roasted red potatoes and buttered corn, including a bottled soda or water
- 12:00 p.m.—5:30 p.m. Quilt Square Viewing and Bidding Lower Lobby 3
- 1:30 p.m.—2:45 p.m. SEMINARS I
Derby Delights German-American Bank A
 Julie Hook, KEHA 2nd Vice President
Food and Finances in the Face of Disaster German-American Bank B
 Dr. Nichole Huff, Kelly May, Annhall Norris, and Dr. Heather Norman-Burgdolf,
 UK Family and Consumer Sciences Extension
Technology You Can Use: YouTube and Zoom German-American Bank C
 Mindy McCulley, UK Family and Consumer Sciences Extension

Please silence all cell phones and electronic devices during sessions.

Tuesday, May 10

1:30 p.m.—2:45 p.m. SEMINARS I (continued)

- Ribbon Pin Weaving with the Cardboard Flat Loom** German-American Bank D
Ruth Chowning, Bullitt County Extension Agent for Family and Consumer Sciences
- Paper Quilling** MR210
Judy Yeager and Jennifer Duvall, Campbell County KEHA Members
- Could Your Kitchen Pass a Food Safety Inspection?** MR220
Diane Mason, Boone County Extension Agent for Family and Consumer Sciences
and Kathy Byrnes Kenton County Extension Agent for Family and Consumer
Sciences
- Hunger in Kentucky: Know More, Do More** MR230
Martha Yount, LaToya Drake, Paul Adkins, Nutrition Education Programs, UK
Family and Consumer Sciences Extension
- Bluegrass and Banjos** West Foyer
Bluegrass Museum Staff

3:15 p.m.—4:30 p.m. SEMINARS II

- Making the Most of Meals While Traveling** German-American Bank A
Sally Mineer, Dr. Nichole Huff, and Dr. Heather Norman-Burgdorf, UK Family and
Consumer Sciences Extension
- Tricks of the Trade: Mindful Eating & Other Strategies to Manage Stress Eating &
Savor Each Eating Experience** German-American Bank B
Dr. Courtney Luecking and Emily DeWitt, UK Family and Consumer Sciences
Extension
- Pin Weaving With Yarns** German-American Bank C
Mary Hixson, Garrard County Extension Agent for Family and Consumer Sciences
- Decorating Your Entire Home with Thrift Shop Finds** . . . German-American Bank D
Sue Berry, McLean County KEHA Member
- Entertaining Littles Ones** MR220
Dr. David Weisenhorn, UK Family and Consumer Sciences Extension
- VSU Reporting Refresher** MR230
Kelly May and Kim Henken, KEHA Advisors (current and outgoing)
- Rural Mental Health & Farm Family Stress** MR231
Dr. Paul Norrod and Laura Weddle, UK Family and Consumer Sciences Extension
- Plate It Up Kentucky Proud Mobile Kitchen** Exhibit Hall 1
Liz Kingsland, UK Family and Consumer Sciences Extension
- Bluegrass and Banjos** West Foyer
Bluegrass Museum Staff

6:00 p.m. Opening Banquet West A-E

Karen Hill, KEHA President, Presiding
Inspirational Thought—Nancy Snouse, Northeast Area President

DINNER

Greetings and Welcome to the 2022 KEHA State Meeting —
Brenda Hamm, Licking River Area President
Introduction of Guests—Karen Hill

Please silence all cell phones and electronic devices during sessions.

Tuesday, May 10

6:00 p.m. Opening Banquet (continued) West A-E

Greetings

Dr. Jennifer Hunter, Assistant Director, Family and Consumer Sciences
Extension, UK College of Agriculture, Food and Environment
Kim Henken, Outgoing KEHA Advisor

Introduction of KEHA Past Presidents—Karen Hill

Speaker Introduction—Karen Hill

Keynote Speaker: Jason Koger

Ovarian Cancer Fund Presentations
Sharon Fields, KEHA Chairman for Food, Nutrition, and Health

Counties with largest donations per member:

- 1st Place—Muhlenberg County
- 2nd Place—Taylor County
- 3rd Place—Mason County

Counties with largest overall donations:

- 1st Place—Taylor County
- 2nd Place—Muhlenberg County
- 3rd Place—Mason County

Counties contributing over \$1,000:

Carroll Mason Muhlenberg Scott Taylor

County with largest number of first time ovarian cancer screening participants:

- 1st Place—Owen County
- 2nd Place—Bourbon County
- 2nd Place—Shelby County
- 3rd Place—Henderson County

Ovarian Cancer Fundraising Contest:

- 1st Place—Mason County
- 2nd Place—Barren County

Presentation to Edward J. Pavlik, PhD, Professor, Division of Gynecologic
Oncology, University of Kentucky Medical Center

Announcements—Karen Hill

OVARIAN CANCER AWARDS

Counties with 100% donations to Ovarian Cancer Research:

(*Denotes counties with over 100% donations.)

<u>Bluegrass</u>	<u>Lake Cumberland</u>	<u>Louisville</u>	<u>Northern Ky</u>	<u>Quicksand</u>
Bourbon	Adair	Bullitt	*Boone	Breathitt
Clark	Clinton	Henry	Campbell	Knott
*Fayette	Cumberland	*Jefferson	*Carroll	Leslie
*Harrison	*Green	*Shelby	Gallatin	Owsley
*Madison	McCreary	Spencer	*Grant	
Nicholas	Pulaski	Trimble	Kenton	
Powell	Russell		Owen	
*Scott	*Taylor		*Pendleton	
	*Wayne			

OVARIAN CANCER AWARDS (continued)

Counties with 100% donations to Ovarian Cancer Research:

(*Denotes counties with over 100% donations.)

<u>Fort Harrod</u> Anderson *Boyle Garrard *Jessamine *Lincoln Mercer *Woodford	<u>Licking River</u> Bath Bracken Fleming Lewis *Mason Menifee Montgomery Morgan Robertson Rowan	<u>Mammoth Cave</u> *Allen *Barren Butler *Edmonson Hart Logan Metcalfe Monroe *Simpson *Warren	<u>Pennyrile</u> Christian Crittenden Hopkins Livingston Lyon *Muhlenberg Todd Trigg	<u>Wilderness Trail</u> Bell Clay Harlan Jackson Knox Laurel Rockcastle Whitley
<u>Green River</u> *Daviss Hancock Henderson McLean Ohio Union Webster	<u>Lincoln Trail</u> *Breckinridge Grayson *Hardin Meade *Nelson	<u>Northeast</u> *Boyd Carter *Floyd Greenup Johnson Lawrence Pike	<u>Purchase</u> Ballard Calloway Carlisle Fulton Hickman McCracken	

Wednesday, May 11

8:00 a.m.—9:45 a.m.	Registration	Registration 3
	Voting Delegate Sign-In	Registration 2
8:00 a.m.—10:00 a.m.	KEHA Merchandise Store	Exhibit Hall 1
	Silent Auction & Raffle Open	Exhibit Hall 1
	Homemaker Showcase Open	Exhibit Hall 1
	Quilt Square Viewing & Bidding	Lower Lobby 3
8:00 a.m.—3:00 p.m.	Cultural Arts Viewing	Exhibit Hall 2
8:00 a.m.—5:00 p.m.	Trade Show Open	Exhibit Hall 1
8:15 a.m.—9:30 a.m.	SEMINARS III	
	Perfect Picnics.	German-American Bank A Angie York, Lyon County Extension Agent for Family and Consumer Sciences
	Move Your Way - Exercise for Everybody.	German-American Bank B Dr. Natalie Jones, UK Family and Consumer Sciences Extension
	Write I Right?	German-American Bank C Rita Bloom, Boyle County KEHA Member
	History of Aprons.	German-American Bank D Nell Jordan and Sharon Taylor-Carillo, Simpson County KEHA Members

Please silence all cell phones and electronic devices during sessions.

Wednesday, May 11

8:15 a.m.—9:30 a.m. SEMINARS III (continued)

- Paper Quilling** MR210
Judy Yeager and Jennifer Duvall, Campbell County KEHA Members
- ACWW** MR220
Leoni Mundelius, Lincoln County KEHA Member
- KEHA - The Leadership Academy** MR230
Sally Mineer, UK Family and Consumer Sciences Extension and Ann Porter,
KEHA Leadership Development Chairman
- Ceiling Fan Blade Santa** MR231
Sue Berry, McLean County KEHA Member
- Plate It Up Kentucky Proud Mobile Kitchen** Exhibit Hall 1
Liz Kingsland, UK Family and Consumer Sciences Extension

9:00 a.m.—5:00 p.m. Vaccination Information Booth Registration 2
Get information, ask questions, and/or register for a vaccination or booster appointment on Thursday.

9:00 a.m.—2:00 p.m. FCS Agent Area Professional Development Bluegrass Museum
(required for agents in attendance)

10:00 a.m.—11:30 a.m. Business Meeting West A-E
(reserved seating for voting delegates)

11:30 a.m.—3:00 p.m. Quilt Square Viewing & Bidding Lower Lobby 3
KEHA Merchandise Store Exhibit Hall 1
Silent Auction & Raffle Open Exhibit Hall 1
Homemaker Showcase Open Exhibit Hall 1

11:30 a.m.—4:00 p.m. Registration Registration 3

11:45 a.m.—1:30 p.m. Master Farm Homemakers Guild Luncheon Riverview Room

OR LUNCH ON YOUR OWN

11:30 a.m.—1:30 p.m. **One-Pass Buffet Lunch available for \$13** Lower Lobby
Tossed salad with ranch dressing, pasta and meatballs in marinara sauce and garlic bread, including a bottled soda or water

1:30 p.m.—2:45 p.m. SEMINARS IV

- What in the World is That? Asian Vegetables 101** German-American Bank A
Leoni Mundelius, Lincoln County KEHA Member, and Rita Stewart, Lincoln
County Extension Agent for Family and Consumer Sciences
- Cherished Possessions: Estate Planning for Non-Titled Property**
. German-American Bank B
Dr. Nichole Huff, UK Family and Consumer Sciences Extension
- Healthy Eating Around the World** German-American Bank C
Janet Mullins, and Dr. Courtney Luecking, UK Family and Consumer Sciences
Extension, and Marilyn Watson, KEHA International Chairman
- Voices of Elmwood** German-American Bank D
Sue Berry, McLean County KEHA Member, and “Voices from the Past”
- Flocking for Fun and Money** MR220
Sharon Wood and Doris Shofner, Taylor County KEHA Members, Ann Porter,
KEHA Leadership Development Chairman, and Tara McCarty, Mason County
FCS Program Assistant

Wednesday, May 11

1:30 p.m.—2:45 p.m. SEMINARS IV (continued)

Live, Work, Play and Pray: Making Faith Communities Healthy SpacesMR230
Dr. Natalie Jones and Dr. Heather Norman-Burgdorf, UK Family and Consumer Sciences Extension

KSU UKY Successful Kentucky Immunization Project SKIP-Covid Project
(no pre-registration; open to all) MR231
Dr. Allison P. Young, Program Leader, Family and Consumer Sciences Extension, Kentucky State University Extension

Plate It Up Kentucky Proud Mobile Kitchen Exhibit Hall 1
Liz Kingsland, UK Family and Consumer Sciences Extension

Bluegrass and Banjos West Foyer
Bluegrass Museum Staff

KEHA Choir Rehearsal West A-E
Wendy Hood, Fort Harrod Area President and KEHA Choir Director

2:00 p.m.—3:30 p.m. Master Farm Homemaker Guild Business Meeting Riverview Room

3:30 p.m.—4:30 p.m. Hands-On Creative Classes—Session 2

Snowman Measuring Stick German-American Bank A
Snowman Lightbulb Ornament German-American Bank B
Rainbow Charm Bracelet German-American Bank C
Red Work/Blue Work German-American Bank D
Travel Kit MR210
Candlewicking MR231

4:00 p.m.—5:00 p.m. Pick up and Pay: Quilt Square Auction Lower Lobby 3

Pick up and Pay: Silent Auction Exhibit Hall 1

Pick up Showcase Displays Exhibit Hall 1

4:00 p.m.—5:00 p.m. Cultural Arts Check Out Exhibit Hall 2
(Areas will be called in reverse order of check-in.)

DINNER ON YOUR OWN

7:00 p.m. General Session West A-E
Julie Hook, KEHA 2nd Vice President, Presiding

Inspirational Thought—Judy Jackson, KEHA Secretary

Greetings

Dr. Laura Stephenson, Associate Dean and Director, Cooperative Extension,
UK College of Agriculture, Food and Environment

Kelly May, KEHA State Advisor

Faye Korthaus, President, Kentucky Master Farm Homemakers Guild

KEHA Choir Performance

Wendy Hood, Fort Harrod Area President and KEHA Choir Director

(See listing of choir members on page 19.)

Introduction of Speaker—Kelly May, KEHA State Advisor

Keynote Speaker: Allen Blair, Kentucky Transportation Cabinet, District 9

Wednesday, May 11

7:00 p.m. General Session (continued) West A-E

Cultural Arts—Barb Seiter, KEHA Cultural Arts & Heritage Chairman
Viewer’s Choice Winner

KEHA Development Grant and Mini-Grant Presentations—
Julie Hook, KEHA 2nd Vice President

- Development Grants:
- Graves County—“Welcome Home”
- Hancock County—“Build a Bed Project-20 Quilt Project”
- LaRue County—“Enriching Our Culture Through Arts and Crafts”
- Monroe County—“Home Alone—Supporting Pollinators”
- Owen County—“Growing Membership with Owen County Homemakers”
- Northeast Area—“Leadership Toolbox: Pop It Up for Homemakers”

Announcement of Theme Basket Winners—Nancy Snouse, Northeast Area President

Announcements—Julie Hook, KEHA 2nd Vice President

Thursday, May 12

7:30 a.m.—8:30 a.m. Registration Registration 3

8:00 a.m.—9:15 a.m. OFFICER TRAINING

- President/President Elect** German-American Bank D
Karen Hill, President
- 1st & 2nd Vice President** German-American Bank C
Henrietta Sheffel, 1st Vice President, and Julie Hook, 2nd Vice President
- Treasurer** German-American Bank B
Harlene Welch, Treasurer
- Secretary** German-American Bank A
Judy Jackson, Secretary

9:45 a.m.—11:00 a.m. EDUCATIONAL CHAIRMEN WORKSHOPS

- Environment, Housing and Energy** German-American Bank A
Linda Padgett, Chairman, and Hardin Stevens, Advisor
- Food, Nutrition and Health** German-American Bank B
Sharon Fields, Chairman, and Dr. Heather Norman-Burgdolf, Advisor
- Leadership Development** German-American Bank C
Ann Porter, Chairman, and Sally Mineer, Advisor
- Cultural Arts and Heritage** German-American Bank D
Barb Seiter, Chairman, and Jeanne Badgett, Advisor
- 4-H Youth Development** MR210
Cathy Kunkel-Mains, Chairman, and Dr. Isaac Hilpp, Advisor
- International** MR220
Marilyn Watson, Chairman, and Dr. Janet Mullins, Advisor
- Family and Individual Development** MR230
Dottie Crouch, Chairman, and Dr. Amy Kostelic, Advisor
- Management and Safety** MR231
Elaine Stevens, Chairman, and Kelly May, Advisor

10:00 a.m.—2:00 p.m. Vaccination Booth Registration 2
COVID-19 vaccination or booster shots available. Walk-ins welcome.

Thursday, May 12

11:30 a.m. Awards Luncheon West A-E

Henrietta Sheffel, KEHA 1st Vice President, Presiding
Inspirational Thought—Diane McCamish, Lincoln Trail Area President

Greetings

Dr. Nancy Cox, Dean, UK College of Agriculture, Food and Environment

LUNCH

AWARDS PRESENTATIONS—KEHA 2022 Awards & Contest Winners

Membership—Julie Hook, 2nd Vice President

Largest Percentage Increase

- 1st Place—Franklin County
- 2nd Place—Casey County
- 3rd Place—Spencer County

Largest Overall Increase

- 1st Place—Scott County
- 2nd Place—Franklin County
- 3rd Place—Mason County

Increase of 25 or more members

- | | | | |
|---------|---------|----------|---------|
| Ballard | Bath | Franklin | Greenup |
| Hardin | Johnson | Mason | Morgan |
| Scott | Spencer | | |

Membership Tenure Recognitions (See page 14.)

Cultural Arts & Heritage—Barbara Seiter, State Chairman

Poetry

- 1st Place—Betty Harris, Mason County
- 2nd Place—Marie Pitts, Simpson County
- 3rd Place—Pamela Lambert, Daviess County

Memoirs

- 1st Place—Mary Coghill, Breckinridge County
- 2nd Place—Linda Owsley, Hardin County
- 3rd Place—Bettina Marple, Hardin County

Short Stories

- 1st Place—Monica Lucas, Meade County
- 2nd Place—Nancy Loyall Turner, Green County
- 3rd Place—Marie Pitts, Simpson County

Passport County Winners

- 1st Place—Muhlenberg County
- 2nd Place—Taylor County
- 3rd Place—Cumberland County

4-H Youth Development—Cathy Kunkel-Mains, State Chairman

Volunteer Hours for 4-H

- 1st Place—Carroll County
- 2nd Place—Mason County
- 3rd Place—Shelby County

Thursday, May 12

11:30 a.m. Awards Luncheon (continued) West A-E

4-H Youth Development—Cathy Kunkel-Mains, State Chairman

4-H Camp Scholarships

1st Place—Greenup County

2nd Place—Mason County

3rd Place—Meade County

Most Innovative 4-H/Homemaker Partnership Project

1st Place—Mason County

Most Innovative 4-H/Homemaker Community Project

1st Place—LaRue County

Environment, Housing and Energy—Linda Padgett, State Chairman

Adopt-A-Highway Awards

1st Place—Mason County Homemakers

2nd Place—Bourbon Bellas from Bourbon County

Family and Individual Development—Dottie Crouch, State Chairman

Nurturing Families Awards

1st Place—Mason County

2nd Place—Filipina Extension Homemaker Club

3rd Place—Barren County

Alzheimer's Awareness Fundraising

1st Place—Morgan County

2nd Place—Montgomery County

Food, Nutrition and Health—Sharon Fields, State Chairman

Promoting a Healthy Kentucky Contest

1st Place—Carlisle County

International—Marilyn Watson, State Chairman

Coins for Change

1st Place—Meade County

2nd Place—Mason County

3rd Place—Pendleton County

Clean Water and Sanitation Project

1st Place—Fleming County

2nd Place—Madison County

Eco Bricks Project

1st Place—Kenton County

International Month Projects and Programs

1st Place—Barren County

2nd Place—Meade County

Leadership Development—Ann Porter, State Chairman

Community Volunteerism Awards

1st Place—Taylor County

2nd Place—Franklin Homemaker Club

3rd Place—Bracken County

Thursday, May 12

11:30 a.m. Awards Luncheon (continued)West A-E

Leadership Development—Ann Porter, State Chairman

Contributions to KEHA Scholarship Awards

- 1st Place—Boyle County
- 2nd Place—Henry County
- 3rd Place—Barren County

Contributions to Local Scholarship Awards

- 1st Place—Northern Kentucky Area
- 2nd Place—Licking River Area
- 3rd Place—Lake Cumberland Area

Volunteer Service Recognitions

Please see pages 12-13 for the listing of top individuals per area for each category of Volunteer Service.

Invitation to 2023 State Meeting—May 9-11, 2023
Vicky Greenwell, Wilderness Trail Area President
Crowne Plaza Hotel, Louisville, KY

Recognition of Outgoing Board Members
Karen Hill, KEHA President

Installation of Officers & Chairmen
Alice Brown, KEHA Parliamentarian and Past President

Closing Remarks

Reciting of the Creed—(See page 20.)

**Make plans to attend the 2023 KEHA State Meeting
at the Crowne Plaza in Louisville!**

May 9-11, 2023

Wilderness Trail will serve as the host area. Check the KEHA website (www.keha.org) this summer for lodging rates and details.



Volunteer Service Recognitions

Top Extension Hours Per Area

Bluegrass—Rebecca Lamb, Estill County—23 hours
Fort Harrod—Claudeca Clarkson, Woodford County—77 hours
Green River—Carolyn Thomas, Union County—60.5 hours
Lake Cumberland—Cyndy Humble, Taylor County— 41 hours
Licking River—Ann Porter, Mason County—375 hours
Lincoln Trail—Marcy Ward, LaRue County—73 hours
Louisville—Terry Heffley, Henry County—32 hours
Mammoth Cave—Sharon Taylor-Carrillo, Simpson County—180 hours
Northeast—Carol Owens, Johnson County—81 hours
Northern Kentucky—Marie VanDiver, Carroll County—1000 hours
Pennyrile—Dianne Higgins, Todd County—250 hours
Purchase—Linda Mitchell, Marshall County—521 hours
Quicksand—Pat Yinger, Letcher County—162 hours

Top KEHA Hours Per Area

Fort Harrod—Claudeca Clarkson, Woodford County—188 hours
Green River—Karen Hill, Henderson County—237 hours
Lake Cumberland—Doris Shofner, Taylor County—1900 hours
Licking River—Ann Porter, Mason County—780 hours
Lincoln Trail—Lois Pressgrove, Nelson County—335 hours
Louisville—Terry Heffley, Henry County—59 hours
Mammoth Cave—Sharon Taylor-Carrillo, Simpson County—180 hours
Northeast—Frecia Spriggs, Johnson County—68 hours
Northern Kentucky—Patty Kost, Grant County—400
Pennyrile—Freda Toomey, Todd County—792 hours
Purchase—Julie Hook, Carlisle County—300 hours
Quicksand—Lucy Scott, Leslie County—860 hours

Volunteer Service Recognitions

Top Community Hours Per Area

Bluegrass—Rebecca Lamb, Estill County—40.5 hours
Bluegrass—Cheyenne Lamb, Estill County—40.5 hours
Fort Harrod—Jeanette Sellers, Woodford County—1091 hours
Green River—Sue Berry, McLean County—780 hours
Lake Cumberland—Veronica Whitehead, Wayne County—2647 hours
Licking River—Pearl Cracraft, Mason County—1685 hours
Lincoln Trail—Dottie Gordon, Breckinridge County—1664 hours
Louisville—Peggy Townsend, Oldham County—136 hours
Mammoth Cave—Sharon Taylor-Carrillo, Simpson County—1968 hours
Northeast—Geneva Slone, Johnson County—520 hours
Northern Kentucky—Brenda Dunn, Grant County—2226 hours
Pennyrile—Tina Riddle, Todd County—2194 hours
Purchase—Peggy Rexroat, Carlisle County—770 hours
Quicksand—Pat Yinger, Letcher County—300 hours

Top Personal Hours Per Area

Bluegrass—Rebecca Lamb, Estill County—63 hours
Fort Harrod—Jo Willis, Jessamine County—1684 hours
Green River—Judy Powell, Henderson County—1750 hours
Lake Cumberland—Ruby Edwards, Wayne County—4008 hours
Licking River—Elizabeth Ann Pendleton, Mason County—5690 hours
Lincoln Trail—Kathy Henning, Breckinridge County—4368 hours
Louisville—Cindy Moore, Henry County—2100 hours
Mammoth Cave—Judy Kirkland, Logan County—2500 hours
Northeast—Mary Ann Rutledge, Johnson County—1440 hours
Northern Kentucky—Brenda Dunn, Grant County—2016 hours
Pennyrile—Cindy Strader, Todd County, 3200 hours
Purchase—Alison Geurin, Calloway County—2076 hours
Quicksand—Lucy Scott, Leslie County—553 hours

KEHA MEMBERSHIP TENURE RECOGNITIONS

50 Year Members:

Eileen Breslin
Patsy Pruitt
Linda Calico
Sue Bradford
Bonnie Miller
Minnie Miller
Laura Nell Kemp
Mae Lykins
Shirley Roe
Ocie Key
Pat Springgate
Jewell Burgett
Peggy Adams

60 Year Members:

Margaret Holland
Patsy Medlin
Stella Barnett
Frances Bennett
Virginia Johnson
Marie Pitts
Betty Rith Ditmore
Martha Moorman
Janie Wilson
Elise Royster
Janet Vanbibber
Maxine Blair

65 Year Members:

Pauline Batts

70 Year Members:

Helen Yonce

55 Year Members:

Carolyn Hast

Stay in the Loop!!

Visit the KEHA web page at www.keha.org.

Like and follow KEHA on Facebook at
[www.facebook.com/Official KEHA](http://www.facebook.com/OfficialKEHA).

Watch for the monthly KEHA News & Notes on the website
and Facebook page.



**Kentucky Extension Homemaker Association
2021-2022 State Board**

Officers

President Karen Hill, Henderson County
1st Vice President for Program Henrietta Sheffel, Breathitt County
2nd Vice President for Member Resources Julie Hook, Carlisle County
Secretary Judy Jackson, Grant County
Treasurer Harlene Welch, Harrison County

Educational Chairmen

Cultural Arts & Heritage Barbara Seiter, Boone County
Environment, Housing and Energy Linda Padgett, Boone County
Family & Individual Development Dottie Crouch, Oldham County
Food, Nutrition & Health Sharon Fields, Greenup County
4-H Youth Development Cathy Kunkel-Mains, Kenton County
International Marilyn Watson, Henderson County
Leadership Development Ann Porter, Mason County
Management & Safety Elaine Stevens, McCracken County
Marketing and Public Relations Chairman Becky Clay, Johnson County

Area Homemaker Presidents

PURCHASE Nancy Smith, Graves County
PENNYRILE Donna Settle, Todd County
GREEN RIVER Edna McCrady, Daviess County
MAMMOTH CAVE Marie Pitts, Simpson County
LAKE CUMBERLAND Cyndy Humble, Taylor County
LINCOLN TRAIL Diane McCamish, Hardin County
LOUISVILLE Kathy Irby, Jefferson County
NORTHERN KENTUCKY Patsy Kinman, Grant County
FORT HARROD Wendy Hood, Mercer County
BLUEGRASS Connie Vaughn, Bourbon County
LICKING RIVER Brenda Hamm, Rowan County
NORTHEAST Nancy Snouse, Greenup County
QUICKSAND vacant
WILDERNESS TRAIL Vicky Greenwell, Laurel County

Other (non-voting Board Members)

Parliamentarian Alice Brown, Greenup County
Master Farm Homemakers Guild Faye Korthaus, Oldham County
KEAFCS Leslie Workman, Pike County
KEHA Advisor Kelly May
Assistant Director, Family & Consumer Sciences Extension Dr. Jennifer Hunter

Family & Consumer Sciences Agents by County

Adair – Dylan Gentry
Allen – vacant
Anderson – Maxwell Alviar
Ballard – Sarah Drysdale
Barren – vacant
Bath – vacant
Bell – Rebecca Miller
Boone – Diane Mason
Boone – Elizabeth Evans
Bourbon – Kay Denniston
Boyd – vacant
Boyle – Alethea Bruzek
Bracken – Shannon Smith
Breathitt – Kayla Watts
Breckinridge – Lynette Allen
Bullitt – Ruth Chowning
Butler – Tracy Cowles
Caldwell – Ashley Board
Calloway – vacant
Campbell – Kate Thompson
Campbell – vacant
Carlisle – Brooke Hogancamp
Carroll – Cathy Jansen
Carter – vacant
Casey – vacant
Christian – Tiffany Bolinger
Clark – Shonda Johnston
Clay – Emily Boggs
Clinton – Christy Nuetzman Stearns
Crittenden – Janeen Tramble
Cumberland – Debbie Messenger
Daviess – Katie Alexander
Edmonson – Julia Wilson
Elliott – vacant
Estill – Judy Vaughn
Fayette – vacant
Fayette - vacant
Fleming – vacant
Floyd – Andrea Stone
Franklin – vacant
Fulton – Anna McCoy
Gallatin – Ronda Rex
Garrard – vacant
Grant – Asa Conkwright
Graves – Denise Wooley
Grayson – Natalie Taul
Green – vacant
Greenup – Lora Pullin
Hancock – vacant
Hardin – Dayna Fentress
Hardin - Chandra DeRamus (KSU)
Harlan – Heather Maggard
Harrison – Shelley Meyer
Hart – vacant
Henderson – Amanda Hardy
Henry – Krista Perry
Hickman – vacant
Hopkins – Amanda Dame
Jackson – vacant
Jefferson – vacant
Jefferson – Jenie Carter (KSU)
Jessamine – Karli Giles
Johnson – Brenda Cockerham
Kenton – Kathy Brynes
Kenton – Joan Bowling
Knott – vacant
Knox – Kelsee Dewees
LaRue – Marla Stillwell
Laurel – Lora Davidson
Lawrence – vacant
Lee – Laken Campbell
Leslie – Vicki Boggs
Letcher – Nanette Banks
Lewis – vacant
Lincoln – Rita Stewart
Livingston – Joni Phelps
Logan – Rachel Hance
Lyon – Angie York
Madison – Jessica Hunley
Magoffin – Cathy Sparks
Marion – Brittany Thomas
Marshall – Vicki Wynn
Martin – Martika McCoy
Mason – vacant
McCracken – Kelly Alsip
McCreary – Leah VanMeter
McLean – vacant
Meade – Jennifer Bridge
Menifee – vacant
Mercer – Tara Duty
Metcalfe – Lynn Blankenship
Monroe – vacant
Montgomery – Sarah Congleton
Morgan – Nellie Buchanan
Muhlenberg – vacant
Nelson – vacant
Nicholas – vacant
Ohio – Nan Montgomery

Family & Consumer Sciences Agents by County

Oldham - Heather Toombs
 Owen – Chelsea Young
 Owsley – Crystal Osborne
 Pendleton – Kenna Knight
 Perry – vacant
 Pike – Leslie Workman
 Powell – Kendyl Redding
 Pulaski – Edith Lovett
 Robertson – vacant
 Rockcastle – Hazel Jackson
 Rowan – Peggy Jones
 Russell – vacant
 Scott – Alivia Faris
 Shelby – Sheila Fawbush

Simpson – vacant
 Spencer – Beth Maxedon
 Taylor – vacant
 Todd – Jill Harris
 Trigg – Cecelia Hostilo
 Trimble – Jane Proctor
 Union – vacant
 Warren – Kristi Shive
 Washington – Cabrina Buckman
 Wayne – Deborah Shepherd
 Webster – Natalie Green
 Whitley – vacant
 Wolfe – vacant
 Woodford – Elizabeth Coots

Regional Extension Directors

Central Region - Natasha Lucas East Region - Daniel Wilson West Region - Anna Porter

Area Extension Directors

East 1/2: Jeff Casada	Central 1/2: Lisa Adams	West 1/2: Robert Tashjian
East 3/4: Judi O'Bryan	Central 3/4: Jenny Cocanougher	West 3/4: Matt Fulkerson
East 5/6: Ty Back	Central 5/6: Willie Howard	West 5/6: Jeremy Teal
East 7/8: Raven Ford	Central 7/8: Mike Meyer	West 7/8: Amber Huffman

University of Kentucky Advisors to State Educational Chairmen

Cultural Arts & Heritage	Jeanne Badgett, Senior Extension Associate for Clothing and Textiles
Environment, Housing and Energy	Hardin Stevens, Senior Extension Associate for Family and Consumer Sciences
Family & Individual Development	Amy Kostelic, Associate Extension Professor/Family Life Specialist
Food, Nutrition & Health	Heather Norman-Burgdolf, Assistant Extension Professor/Food & Nutrition Specialist
4-H Youth Development	Isaac Hilpp, Senior Extension Specialist for 4-H Youth Development
International	Janet Mullins, Extension Professor, Department of Dietetics and Human Nutrition
Leadership Development	Sally Mineer, Extension Specialist for Professional Development
Management & Safety	Kelly May, Senior Extension Associate for Family Finance and Resource Management
Marketing and Public Relations	Mindy McCulley, Extension Specialist for Instructional Support

KEHA Presidents

1932-33	* Mrs. Lyda Lynch Hall, Fayette County
1934-35	* Mrs. W.M. Oliver, McCracken County
1936-38	* Mrs. T.M. Johnston, Warren County
1939-41	* Mrs. H.L. Crafton, Henderson County
1941-43	* Mrs. P.W. Adkins, Bell County
1943-45	* Mrs. Ralph Searce, Shelby County
1945-46	* Mrs. W.E. Nichols, Fayette County
1946-49	* Mrs. W.K. Morris, Christian County
1950-53	* Mrs. Wade Hold, Nelson County
1953-56	* Mrs. R. Matchett, Kenton County
1956-59	* Mrs. Virgil Grayson, Pulaski County
1959-62	* Mrs. Carl Evans, Ballard County
1962-65	* Mrs. Harry J. Braun, Campbell County
1965-68	* Mrs. James T. Brookshire, Breckinridge County
1968-71	* Mrs. Earl Friedly, Scott County
1971-74	* Mrs. Howard Taylor, Harrison County
1974-77	* Mrs. Mitchell Bertram, Barren County
1977-80	* Mrs. Samuel Whitt, Jr., Boyd County
1980-83	* Mrs. James Wallace, Caldwell County
1983-86	* Mrs. M.D. Perkins, Campbell County
1986-89	Mrs. L.E. Moorhead, Bracken County
1989-92	* Helen Palmer, Clark County
1992-95	Jean Davis, Hardin County
1995-98	Velma Koostra, Warren County
1998-2001	* Kathleen Hockersmith, Oldham County
2001-04	* Mabel Harned, Nelson County
2004-07	* René Siria, Franklin County
2007-10	Linda Kaletch, McCracken County
2010-13	Alice Brown, Greenup County
2013-16	Susan Hansford, Pulaski County
2016-17	* Mary Margaret Krahulec, Shelby County
2017-19	Marlene McComas, Grant County
2019-22	Karen Hill, Henderson County

* Deceased



2022 KEHA Choir
Directed by: Wendy Hood,
Mercer County



Jean Aull, Breckinridge County
Joan Beard, Anderson County
Rose Booth, Grayson County
Kim Brookshire, Clark County
Wanda Burgin, Mercer County
Denise Dean, Pendleton County
Aggie Fink, Montgomery County
JoAnn Fletcher, Martin County
Teresa Goggin, Boyle County
Chris Goodhue, Taylor County
Regina Goodman, Hardin County
Holly Gregory, Breckinridge County
Brenda Hammons, Lincoln County
Susan Hansford, Pulaski County
Starlene Harris, Carter County
Wendy Hood, Mercer County

Kathy King, Boyd County
Loraine King, Jessamine County
Flo McDonald, Pendleton County
Louise Moneyhon, Bracken County
Diana Morgan, Grant County
Ann Porter, Mason County
Jan Powell, Christian County
Marilyn Powell, Mercer County
Lois Pressgrove, Nelson County
Jane Qualls, Carter County
Phyllos Ross, Harrison County
Pat Sullivan, Ballard County
Tina Wehrle, Kenton County
Diane Williams, Menifee County
Bobbie Wray, Ballard County
Karen Yerkey, Breckinridge County

Ever Onward

Winner, National Home Demonstration Council Song Contest, September, 1956

Words by Dorothy D. Bullock of Kentucky and Music by Max Exner

Like the music of a mighty band
Our voices ring across the land
Singing of duty nobly done
While we advance as one!

Onward, ever onward with a strength born of unity
To our God, our home, and country we will pledge our loyalty

Armed with faith and zeal throughout our days
We'll keep the heart of home ablaze
Striving for better ways to live
Living to serve and give!

Onward, ever onward with a strength born of unity
To our God, our home, and country we will pledge our loyalty

Let us make each home a beacon light
To guide our nation's course a-right
Spreading with gentle heart and hand
Peace over all the land!

Onward, ever onward with a strength born of unity
To our God, our home, and country we will pledge our loyalty

Kentucky Homemaker Creed

I believe in the home as an inspiring and happy center of family life - comfortable and attractive - a place for relaxation and work where pleasures and responsibilities are shared.

I believe in the home and its contribution to community life which reflects the development of the homemaker and the family.

I believe in the homemaker - alert, diligent, in search of better ways of doing ordinary things for the welfare and happiness of the family.

I believe in the homemaker as a community leader responsible for passing on to others mastered skills and knowledge.

I believe in the fellowship that comes through the homemakers organization - the exchange of ideas and the joy of knowledge shared with others, thus broadening our lives and lifting household tasks above the commonplace.

For these opportunities I am grateful.
I am also thankful for the courage of yesterday,
the hope of tomorrow,
and a growing consciousness of God's love always.

Trade Show Vendors

*We extend sincerest thanks to all of the vendors
at our 2022 Trade Show.*

- Kentucky Extension Homemakers Association Merchandise
- Omadarlings (fabric and sewing)
- Sheila's Sculptured Jewelry
- Cedar Hill Baskets
- Fabric Shop
- The Silver Lady (jewelry)
- Dawn's Warehouse (clothing)
- Mary's Magnetic Jewelry (jewelry and cosmetics)
- D's Purses & Accessories
- Sherry A. Burton, LLC (books)
- Ovarian Awareness of KY
- Sun Sugar Farms, LLC (reusable crates and other items)
- Sara Dukes McDonough (leather, glass, vinyl, acrylic applications)
- LeeAnn Norris (Tupperware)
- Pink Zebra Divine (jewelry)
- Old2New4You (jewelry)
- Usborne Books and More



Thank You

***A special thank you goes to all those who helped make the
2022 KEHA State Meeting a success ~***

to the Licking River Area Host Committee, and
Brenda Hamm, Licking River Area President;
to each of the 14 areas for fulfilling their assigned responsibilities;
to the KEHA Executive Committee and Educational Chairmen;
to the Extension agents, specialists, and all presenters of learning sessions;
and to the KEHA Choir and all of our speakers ~
thank for you sharing your time and talent.

1st Floor / Lower Level

Exhibit Hall 1

Exhibit Hall 2

Exhibit Hall 3

East Lower Lobby

Café

Registration 2 and 3

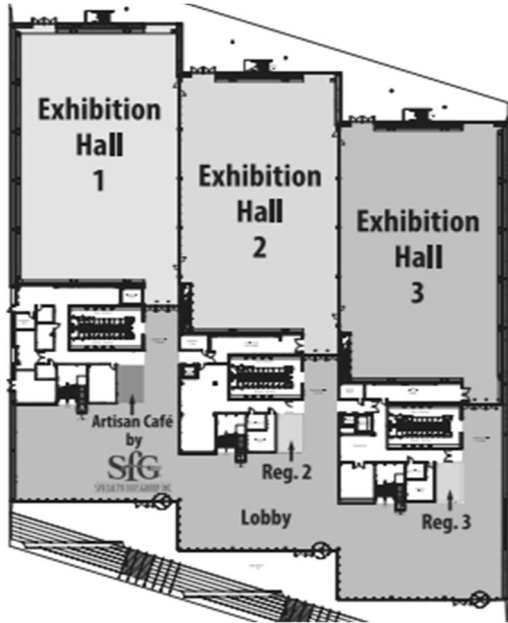

2nd Level / Mezzanine Level

Meeting Room 210

Access via West Escalator

Meeting Room 220

Access via West Elevator

Meeting Room 230

Access via East Elevator

Meeting Room 231

Access via East Elevator

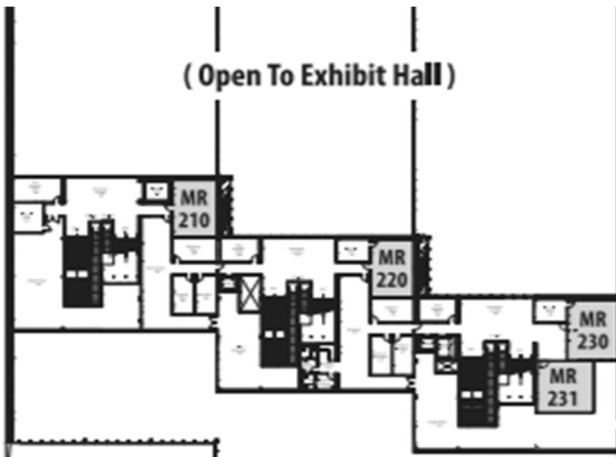

3rd Level / Upper Level

East (German– American Bank) Ballrooms A, B, C, D, E

West Ballroom A, B, C, D, E

Riverview Room

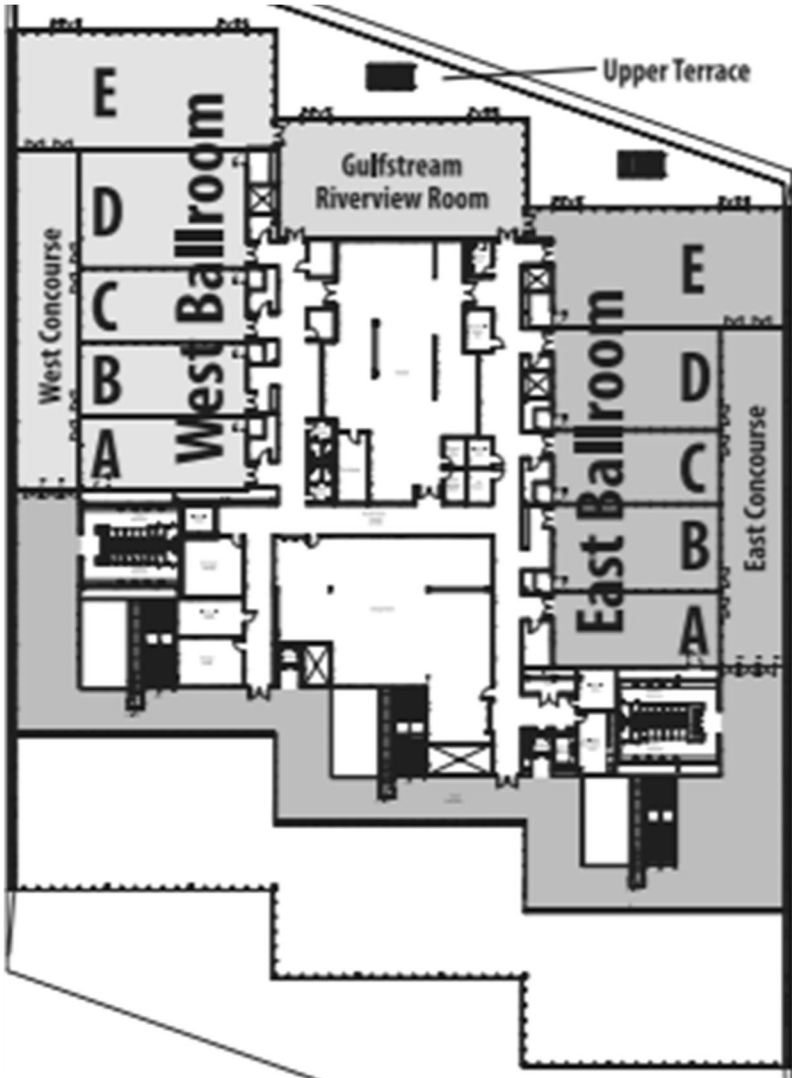

With 10 as the most favorable rating and 1 as the least, please rate the quality of the overall meeting.

Overall Meeting

1 2 3 4 5 6 7 8 9 10

What session did you find most beneficial?

Please share one thing you learned that you plan to implement in your club or county.

Is there someone you would like to hear or would recommend as a keynote speaker for next year?

Is there a seminar topic or presenter you would suggest for next year?

Additional Comments:

Notes
